

# Burlington Township School District Arrival

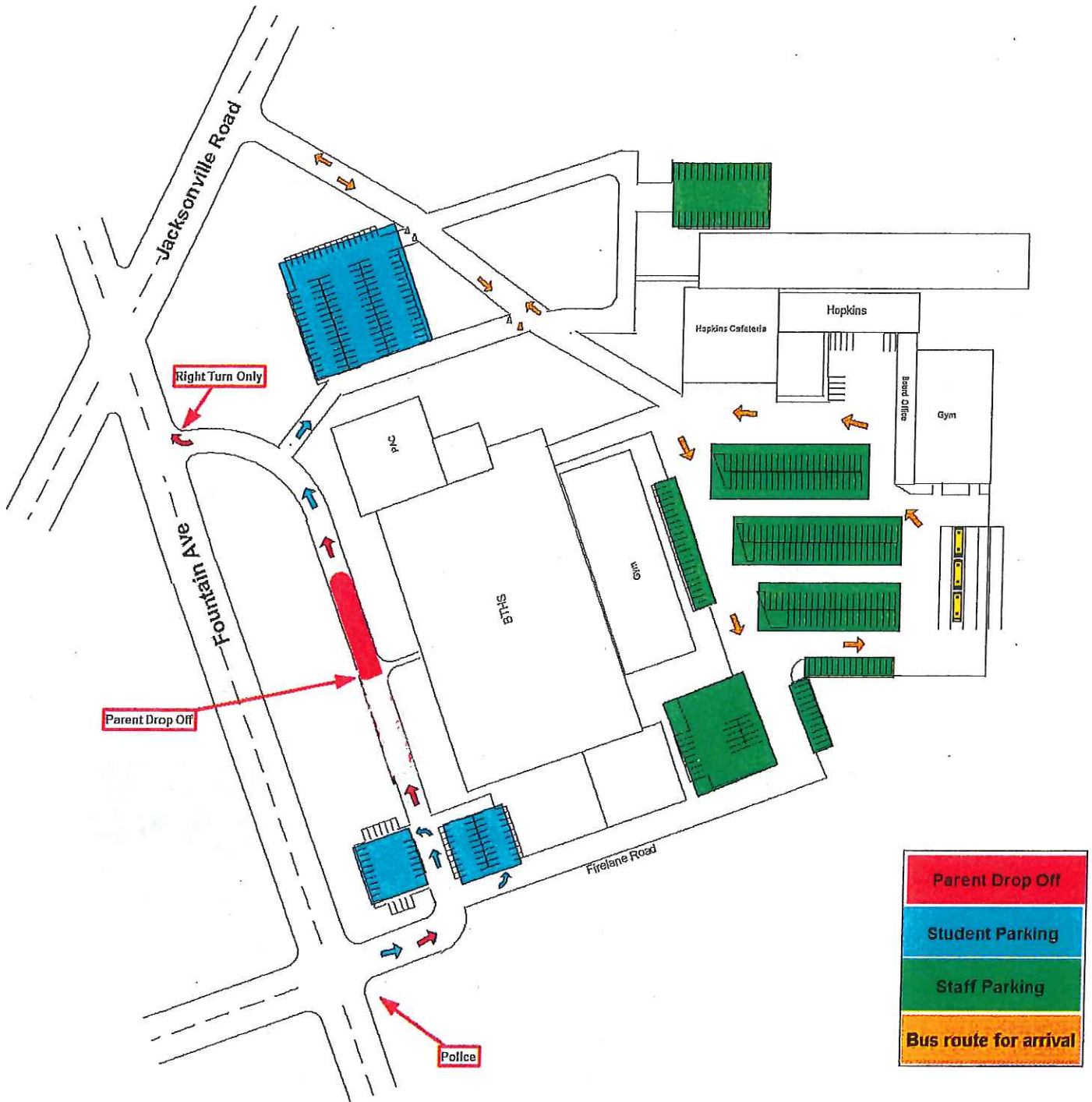

## Please Note: New Traffic Patterns for Burlington Township High School

During arrival and dismissal all student and parent traffic should use the Fountain Avenue entrance to the High School. Jacksonville Road traffic during these times should be limited to busses only. Student parking has been increased to include all parking in front of the D wing.

# Burlington Township School District Dismissal

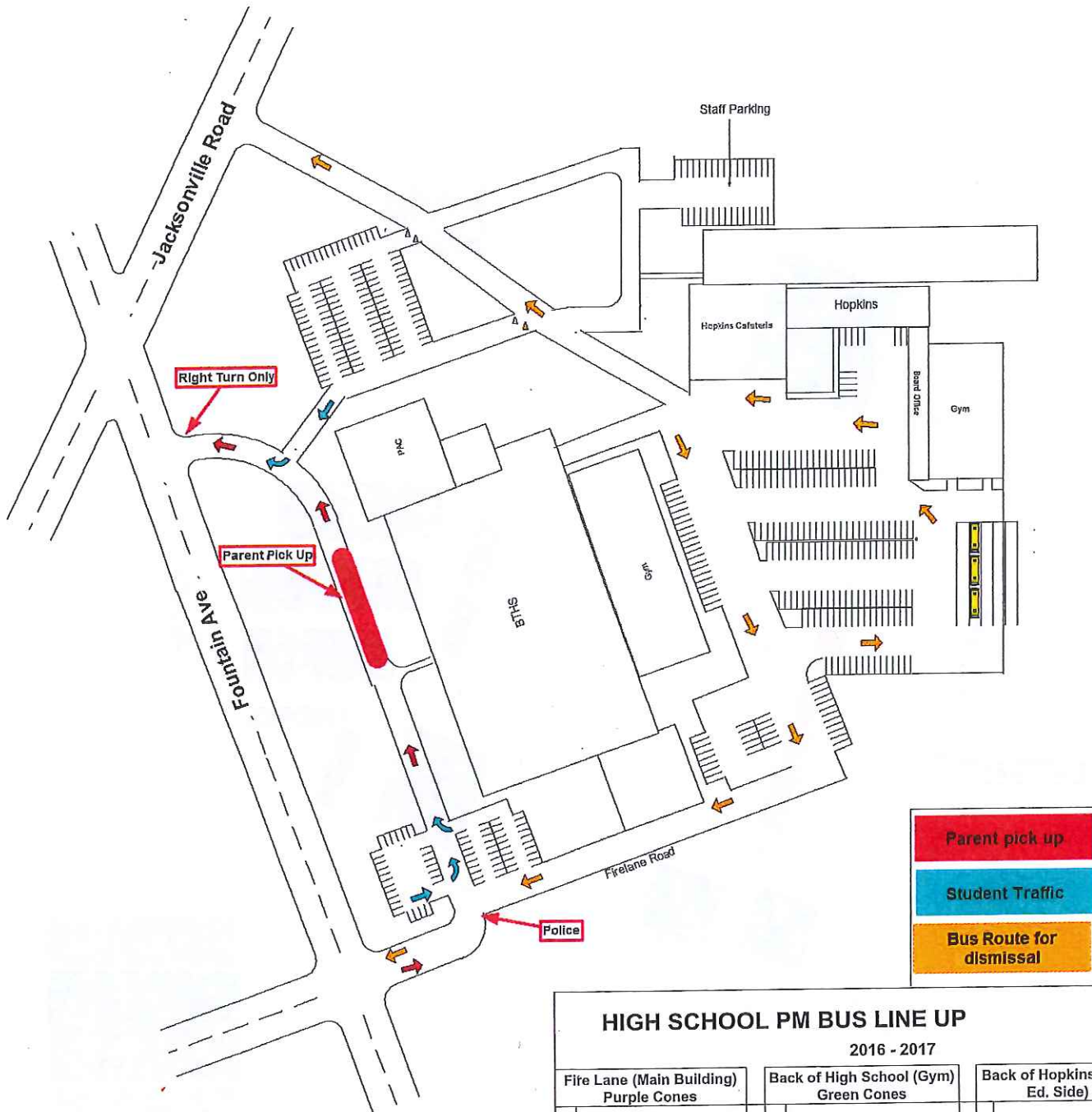

Parent pick up
Student Traffic
Bus Route for dismissal

HIGH SCHOOL PM BUS LINE UP									
2016 - 2017									
Fire Lane (Main Building) Purple Cones			Back of High School (Gym) Green Cones			Back of Hopkins Building (Board of Ed. Side) - Blue Cones			
	Bus number			Bus number			Bus number		
1	54		1	163		1	97		
2	164		2	49		2	68		
3	93		3	94		3	85		
4	96		4	66		4	90		
5	86		5	65		5	82		
6	143		6	84		6	57		
7	47		7	87		7	91		
8	67		8	145		8	81		
9			9	48		9			
10			10	98		10			